

# Installation Procedure

## WARNING ⚡

- 1.Switch off before installation / maintenance.
- 2.Switch on only after complete installation and examination of the circuit.
- 3.Professional electrician for installation and maintenance only.

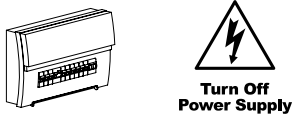

Turn Off power supply before starting any installation. Read instructions & check you have all the tools & accessories to complete the installation correctly.

## How to install

### Step 1

Remove the side cap screws with a hex wrench, then open the cover.

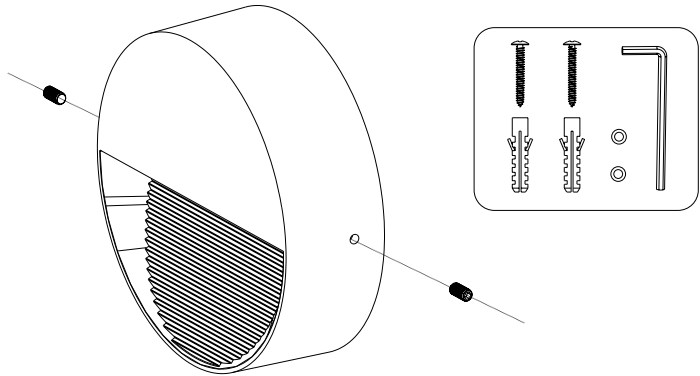

### Step 2

Turn off power supply, according to lamp base mounting holes, drill holes in needed position, then fix the lamp base on the wall.

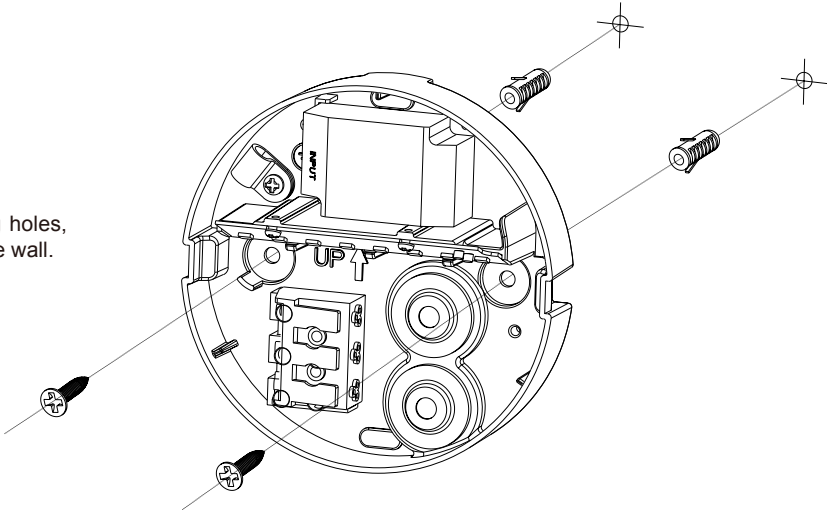

### Step 3

Connect AC wires correspondingly.

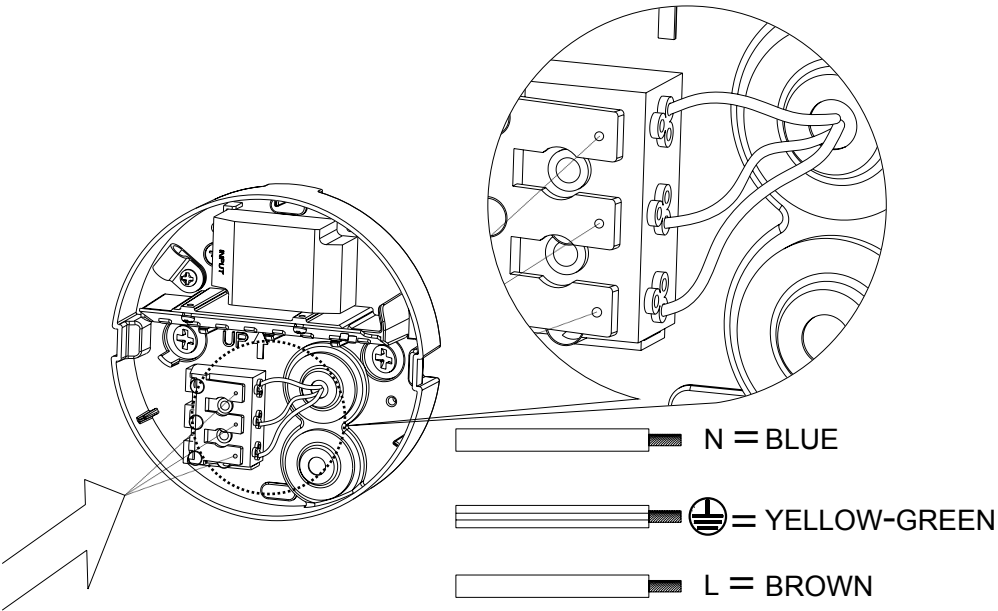

### Step 4

Fix the cover with side cap screws.

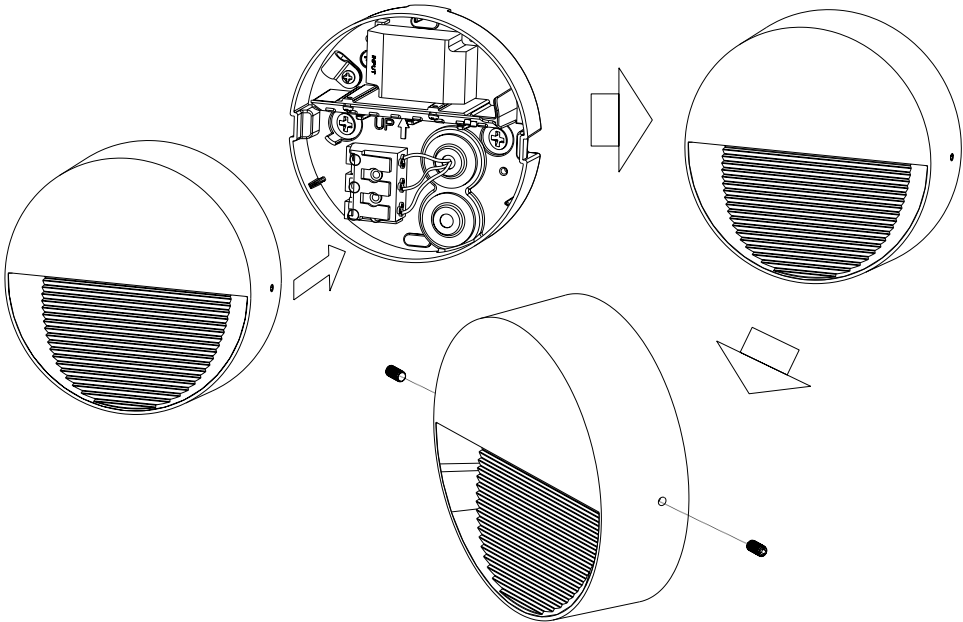

### Step 5

Turn on.

