

Installation Procedure

WARNING

1. Switch off power supply before installation / maintenance.
2. Switch on only after complete installation and examination of the circuit.
3. Professional electrician for installation and maintenance only.



How to install ?

4-wires, 3-circuit

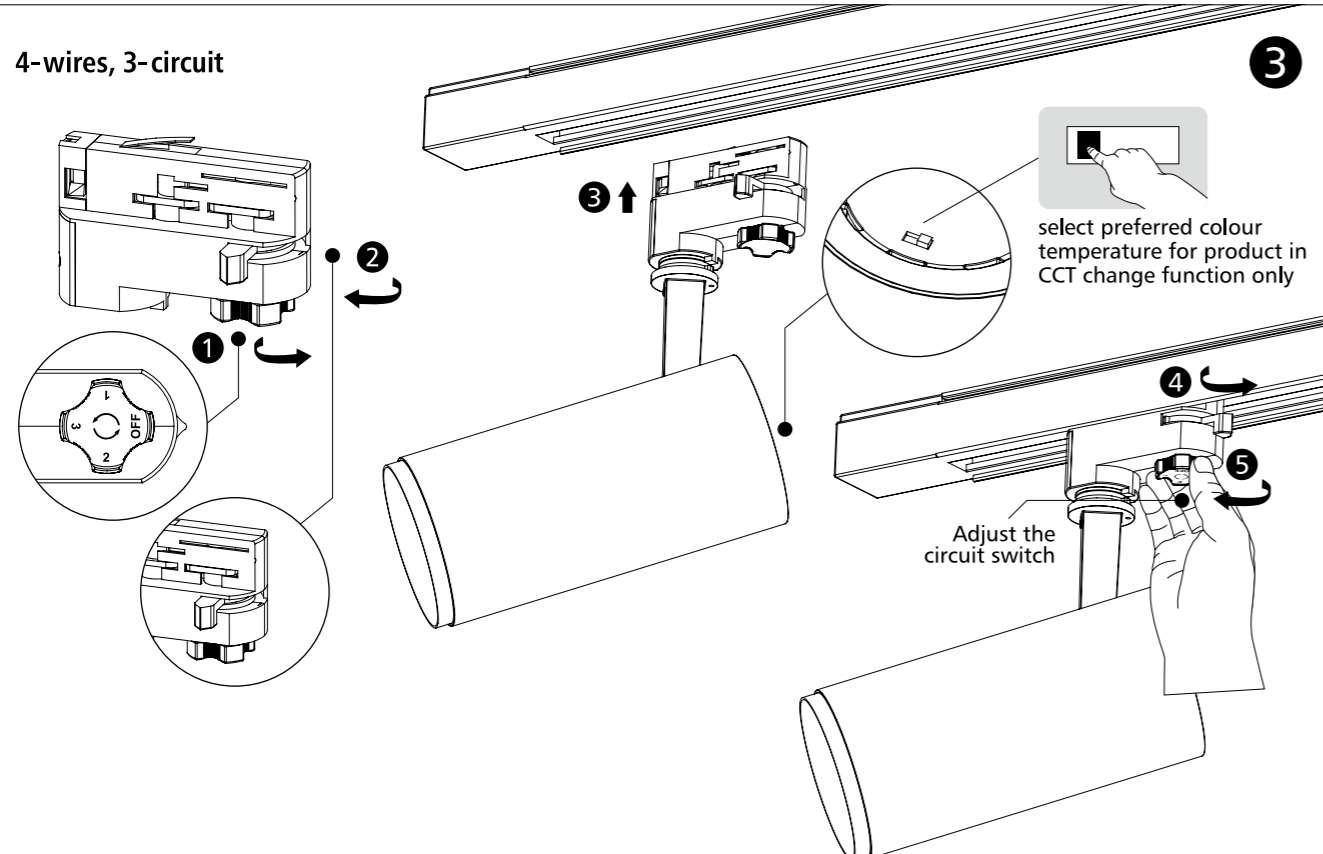

6-wires, 3-circuit (DALI)

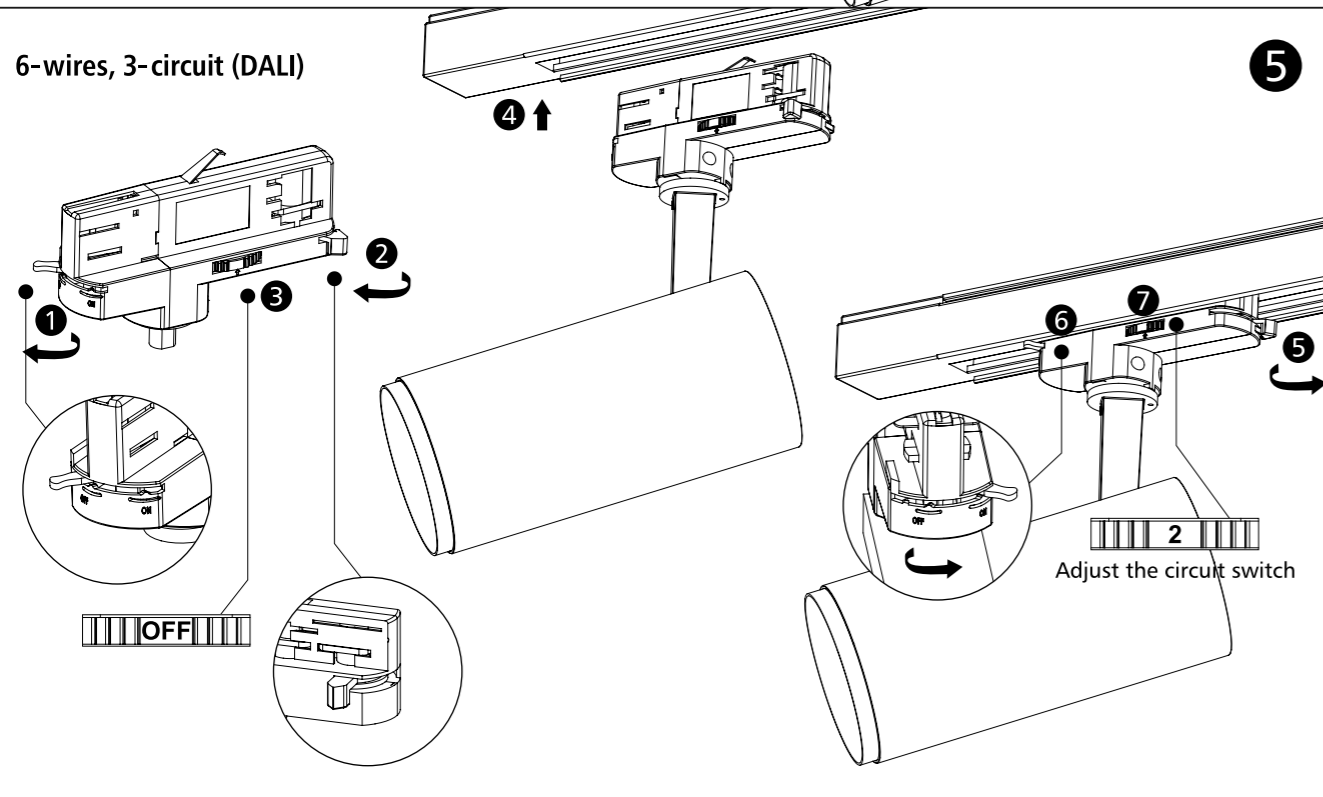

2-wires, 1-circuit

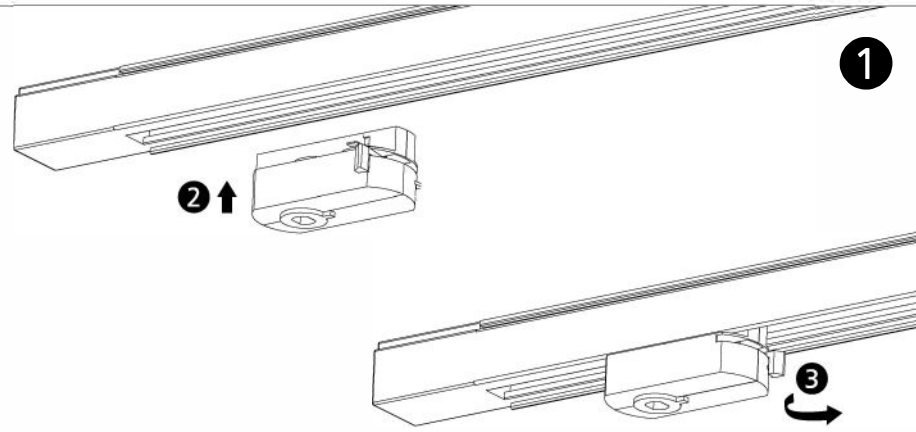
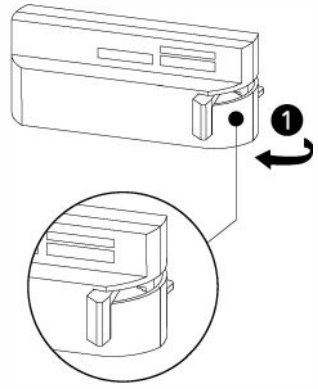

3-wires, 1-circuit

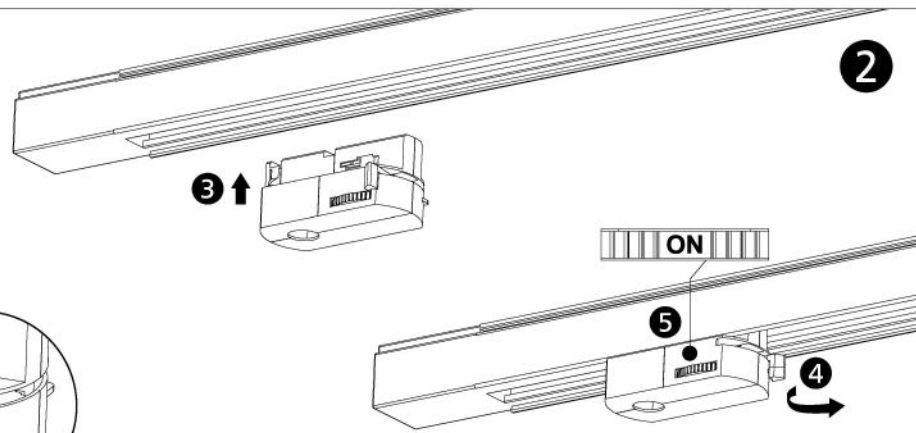
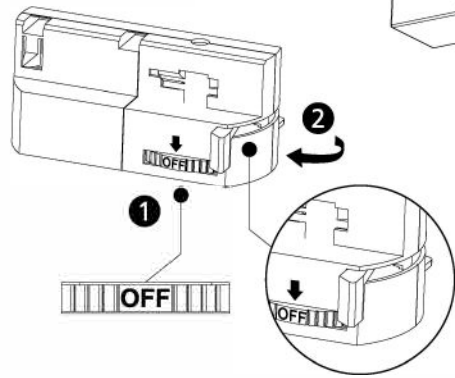

4-wires, 1-circuit (0-10V / DALI)

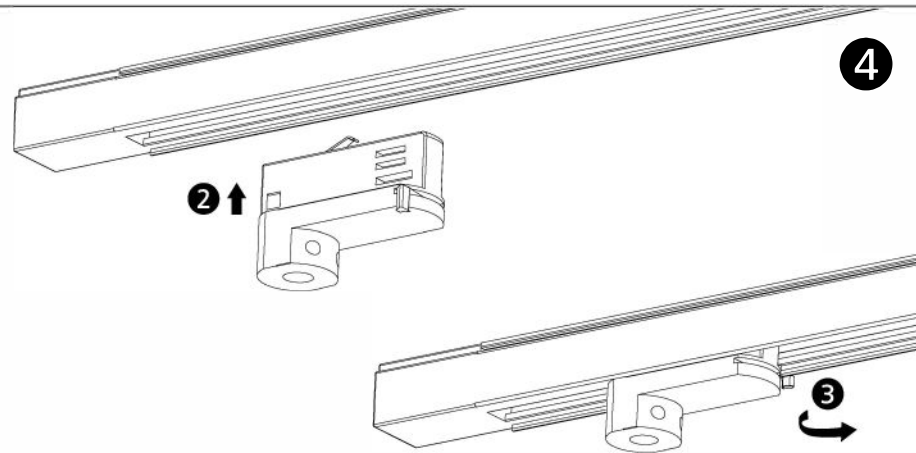
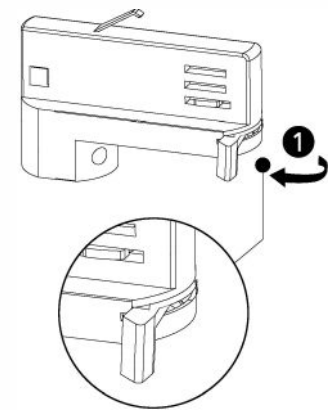

Installation for track

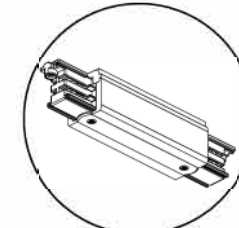
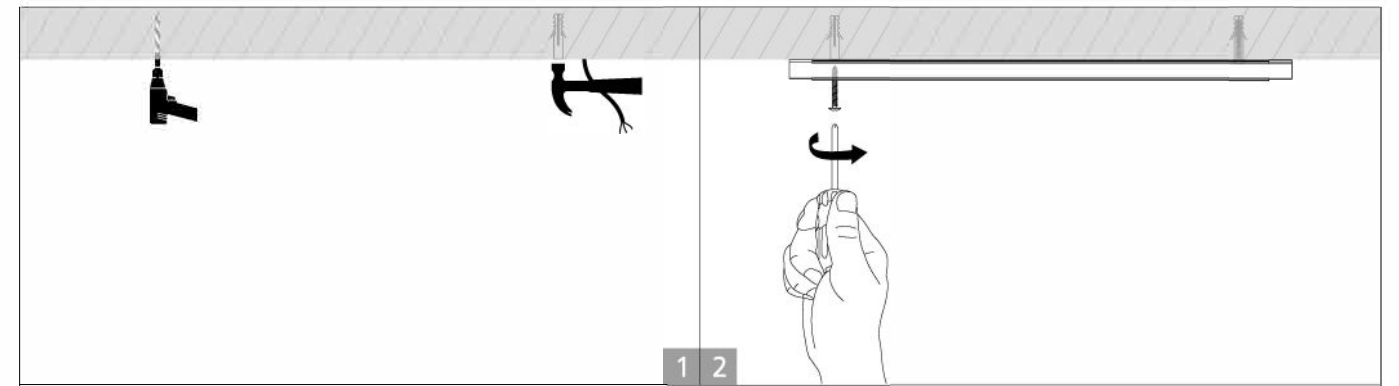

Straight "-"

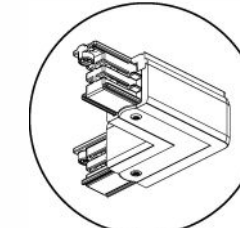

Corner "L"

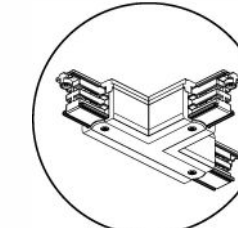

"T" shape

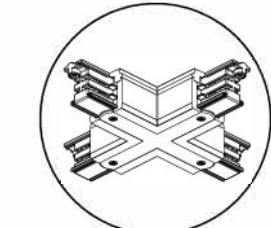

Cross "+"

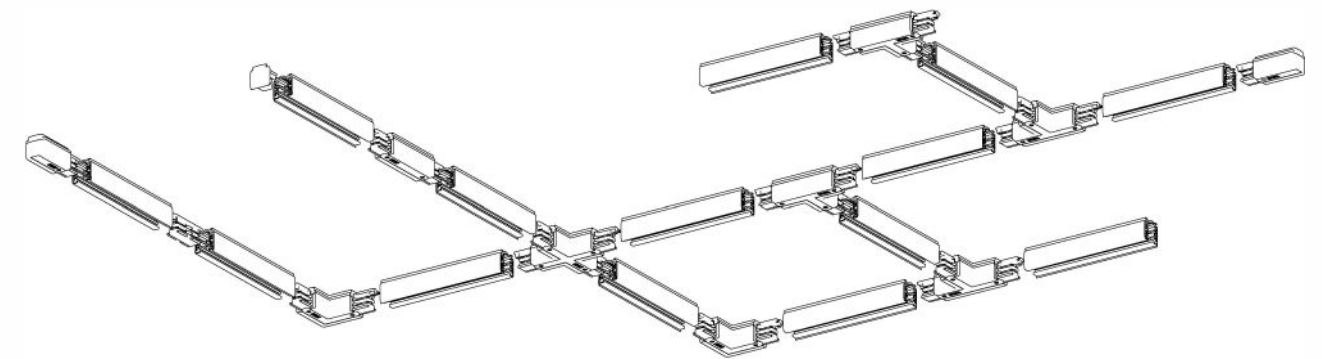

Note: Do not install in the place near heat source, or in corrosive gas environment.